

FlowSmart LeakStop 1 Channel

YS5009-UC

Quick Start Guide
Revision Nov. 22, 2024

A Welcome!

Thank you for purchasing YoLink products! We appreciate you trusting YoLink for your smart home & automation needs. Your 100% satisfaction is our goal. If you experience any problems with your installation, with our products or if you have any questions that this manual does not answer, please contact us right away. See the Contact Us section for more info.

Thank you!
YoLink Customer Support

The following icons are used in this guide to convey specific types of information:

- Very important information (can save you time!)
- Good to know info but may not apply to you

B Before You Begin

Please note: this is a quick start guide, intended to get you started on the installation of your FlowSmart LeakStop 1 Channel. Download the full Installation & User Guide by scanning this QR code:



Installation & User Guide

You can also find all guides and additional resources, such as videos and troubleshooting instructions, on the FlowSmart LeakStop 1 Channel Product Support page by scanning the QR code on the right or by visiting:



Product Support
Support produit
Soporte de producto

<https://www.yosmart.com/support/YS5009-UC>



Your FlowSmart LeakStop 1 Channel connects to the internet via a YoLink hub, and it does not connect directly to your WiFi or local network. In order for remote access to the device from the app, and for full functionality, a hub is required. This guide assumes the YoLink app has been installed on your smartphone, and a YoLink hub is installed and online (or your location, apartment, condo, etcetera, is already served by a YoLink wireless network).

C In the Box

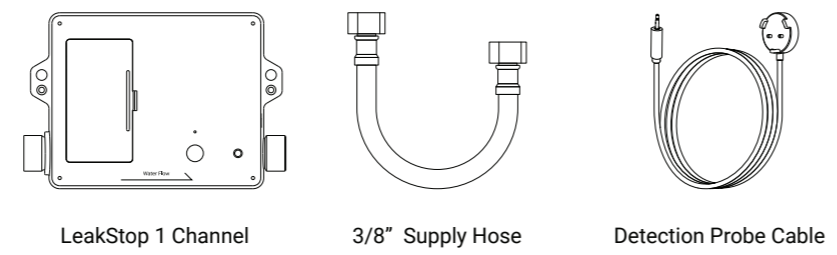

LeakStop 1 Channel 3/8" Supply Hose Detection Probe Cable



2 x AA Batteries (Pre-Installed) Double-Sided Tape x 2 (30*60mm) Quick Start Guide

D Required Items

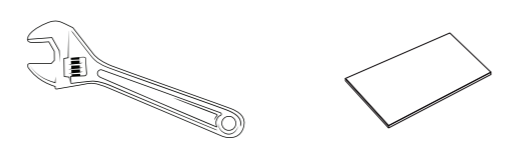

Adjustable Wrench Double-Sided Tape

E Get to Know Your LeakStop 1 Channel

LeakStop 1 Channel:

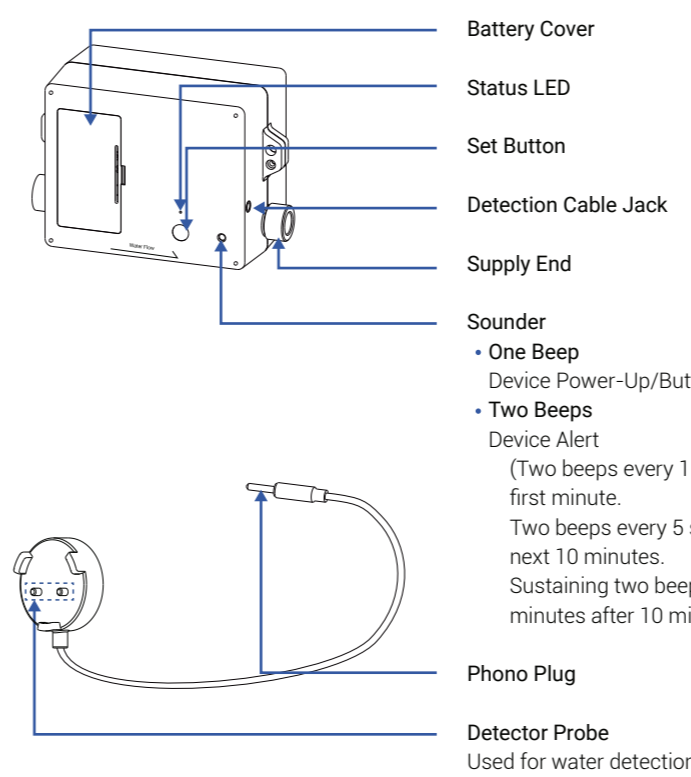

- Battery Cover
- Status LED
- Set Button
- Detection Cable Jack
- Supply End
- Sounder
 - One Beep: Device Power-Up/Button Pressed
 - Two Beeps: Device Alert
 - (Two beeps every 1 second for the first minute. Two beeps every 5 seconds for the next 10 minutes. Sustaining two beeps once 10 minutes after 10 minutes.)
- Phono Plug
- Detector Probe: Used for water detection

LED Behaviors

- Blinking Red Once, Then Green Once: Device Start-Up
- Blinking Red And Green Alternately: Restoring to Factory Defaults
- Blinking Red Once: Valve Closing or Device Alert
- Blinking Green Once: Valve Opening
- Slow Blinking Green Twice: Connecting to Hub
- Quick Blinking Red Twice: Valve is Closed
- Quick Blinking Green Twice: Valve is Open
- Quick Blinking Green: Control-D2D Pairing in Progress
- Quick Blinking Red: Control-D2D Unpairing in Progress
- Slow Blinking Green: Updating
- Fast Blinking Red Once Every 30 Seconds: Low Battery, Replace Batteries Soon

F Install the App

If you are new to YoLink, please install the app on your phone or tablet, if you have not already. Otherwise, please proceed to the next section.

Scan the appropriate QR code below or find the "YoLink app" on the appropriate app store.



Apple phone/tablet
iOS 9.0 or higher



Android phone/
tablet 6.0 or higher

You will immediately receive a welcome email from no-reply@yosmart.com with some helpful information. Please mark the yosmart.com domain as safe, to ensure you receive important messages in the future.

Log in to the app using your new username and password.

The app opens to the **Favorite** screen. This is where your favorite devices and scenes will be shown. You can organize your devices by room, in the **Rooms** screen, later.

Refer to the full user guide and online support for instructions on the use of the YoLink app.

Open the app and tap **Sign up** for an account. You will be required to provide a username and a password. Follow the instructions, to set up a new account. Allow notifications, when prompted.

G Add Your LeakStop 1 Channel to the App

1. Tap **Add Device** (if shown) or tap the scanner icon:

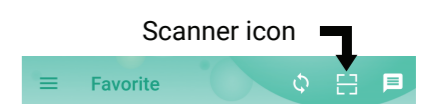

2. Approve access to your phone's camera, if requested. A viewfinder will be shown on the app.

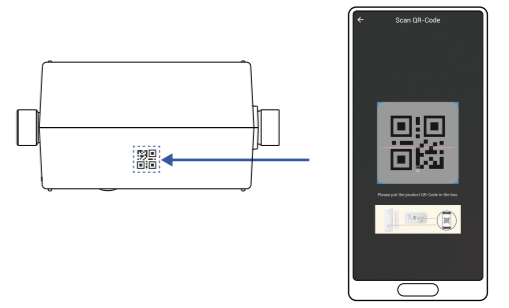

3. Hold the phone over the QR code so that the code appears in the viewfinder. If successful, the **Add Device** screen will be displayed.

4. Follow the instructions to add your LeakStop 1 Channel to the app.

H Before Installation

1. Please install following the water flow direction shown by the arrow.
2. This product defaults to a Maximum Water Usage Duration per Flush of 10 minutes, Maximum Flushes in one day of 20 times, and Maximum Water Usage in one day of 150 gallons. Exceeding any of these limits will automatically close the valve. You can manually reopen the valve in the App (YoLink Hub required) or by pressing the SET button.
3. If you need to modify the default values, please do so on the device detail page within the YoLink App (YoLink Hub required).

I Install the LeakStop 1 Channel

1. Turn off the water valve and loosen the connection between the water valve and the toilet hose.

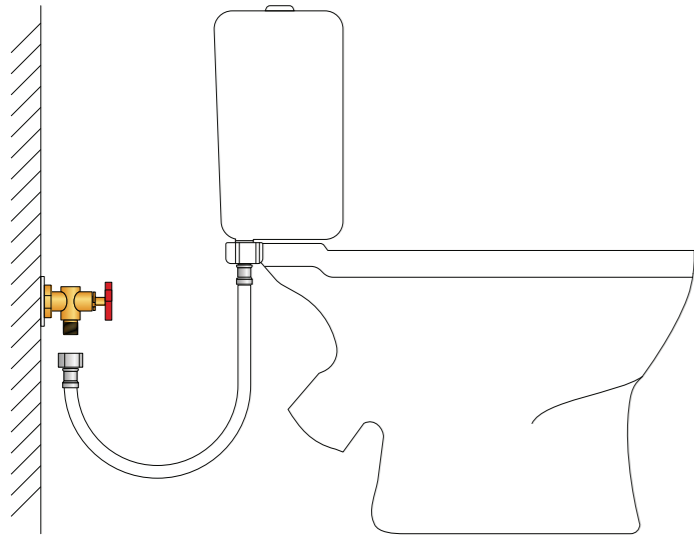

2. Connect the new hose, with one end attached to the valve and the other end to the LeakStop 1 Channel.

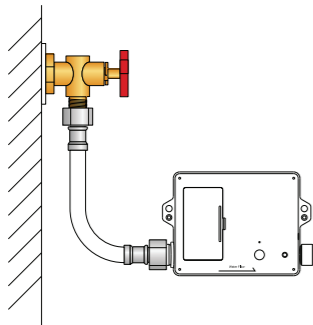

J Install the LeakStop 1 Channel, Continued

3. Reconnect the original hose to the LeakStop 1 Channel.

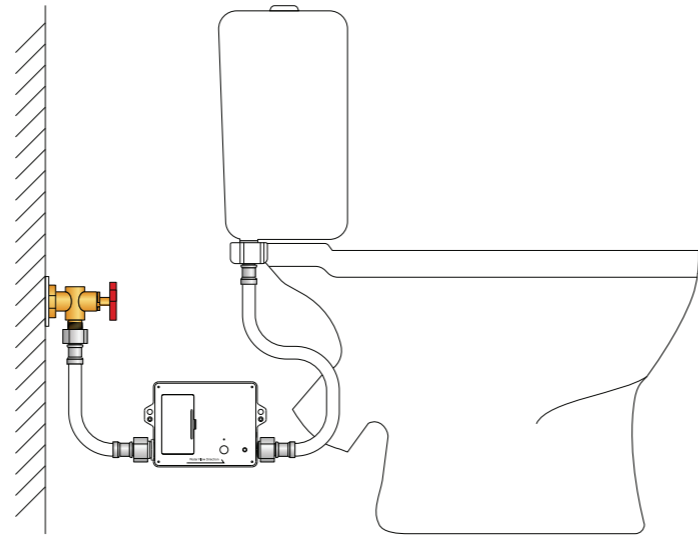

4. Attach the double-sided tape to the back of the LeakStop 1 Channel, peel off the protective film, and secure it to the wall, if required.

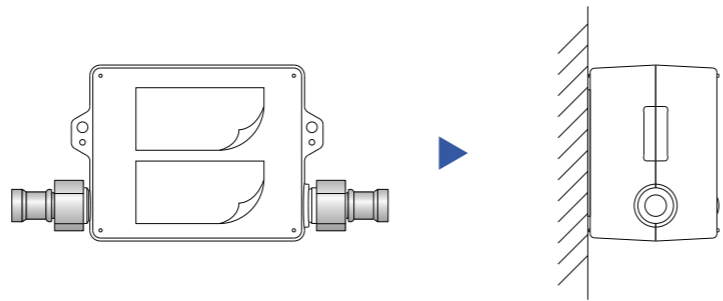

5. Turn on the water valve, then press the SET button to test the LeakStop 1 Channel's on/off functionality.

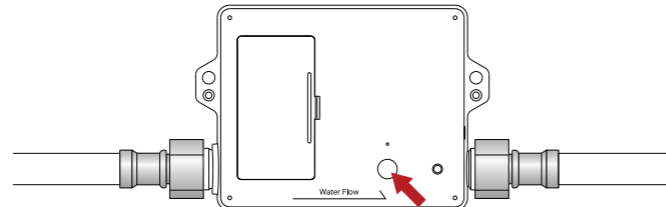

J Install the Probe Detection Cable

1. Connect the cable to the LeakStop 1 Channel, by plugging the male end of the probe cable into the device.

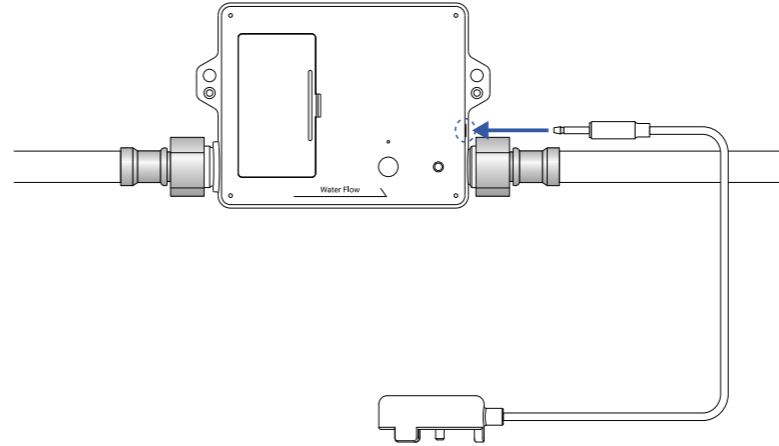

2. Secure the probe cable along the wall, ensuring the cable's end is in close contact with the floor (the device will trigger an alarm when water connects the probes).

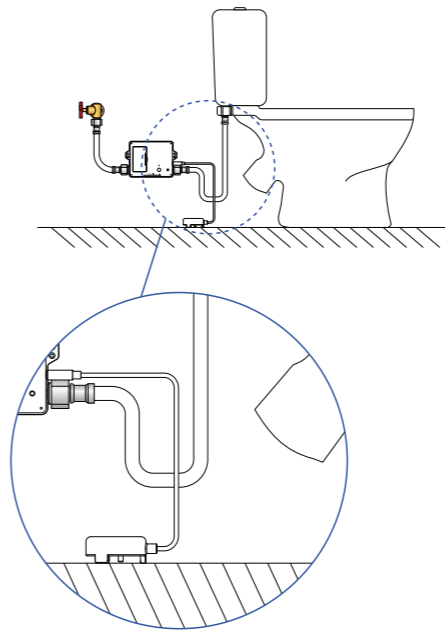

K Power up

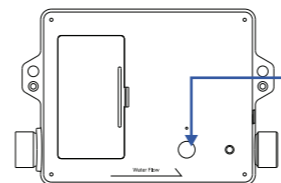

Power up the FlowSmart LeakStop 1 Channel by briefly pressing the SET button, until the LED flashes (red, then green).

L Contact Us

We are here for you if you ever need any assistance installing, setting up or using a YoLink app or product!

Need help? For fastest service, please email us 24/7 at service@yosmart.com

Or call us at **831-292-4831** (US phone support hours: **Monday - Friday, 9AM to 5PM Pacific**)

You can also find additional support and ways to contact us at: www.yosmart.com/support-and-service

Or scan the QR code:



Support Home Page

Finally, if you have any feedback or suggestions for us, please email us at feedback@yosmart.com

Thank you for trusting YoLink!

YoLink Customer Support

YOLINK

25172 Arctic Ocean Drive, Suite 106 Lake Forest, CA 92630

© 2024 YOSMART INC. CALIFORNIA, USA

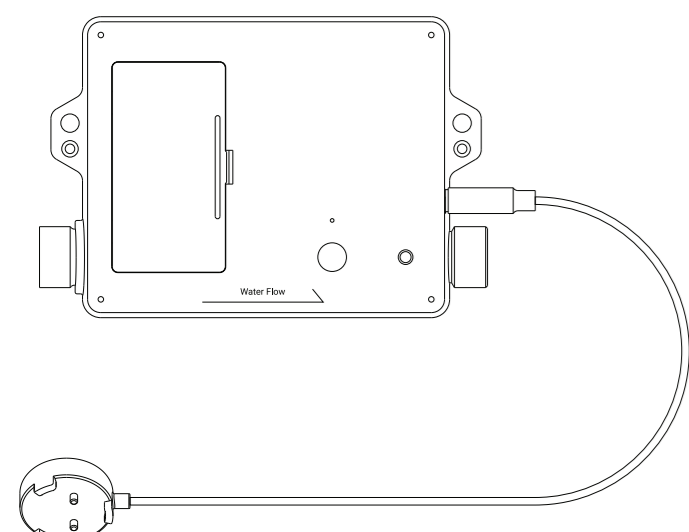

FlowSmart LeakStop 1 Channel

YS5009-UC

Quick Start Guide

Revision Nov. 22, 2024

A Welcome!

Thank you for purchasing YoLink products! We appreciate you trusting YoLink for your smart home & automation needs. Your 100% satisfaction is our goal. If you experience any problems with your installation, with our products or if you have any questions that this manual does not answer, please contact us right away. See the Contact Us section for more info.

The following icons are used in this guide to convey specific types of information:

- Very important information (can save you time!)
- Good to know info but may not apply to you

Thank you!

YoLink Customer Support

B Before You Begin

Please note: this is a quick start guide, intended to get you started on the installation of your FlowSmart LeakStop 1 Channel. Download the full Installation & User Guide by scanning this QR code:



Installation & User Guide

You can also find all guides and additional resources, such as videos and troubleshooting instructions, on the FlowSmart LeakStop 1 Channel Product Support page by scanning the QR code on the right or by visiting:



Product Support Support produit Supporte de producto

<https://www.yosmart.com/support/YS5009-UC>



Your FlowSmart LeakStop 1 Channel connects to the internet via a YoLink hub, and it does not connect directly to your WIFI or local network. In order for remote access to the device from the app, and for full functionality, a hub is required. This guide assumes the YoLink app has been installed on your smartphone, and a YoLink hub is installed and online (or your location, apartment, condo, etcetera, is already served by a YoLink wireless network).

C In the Box

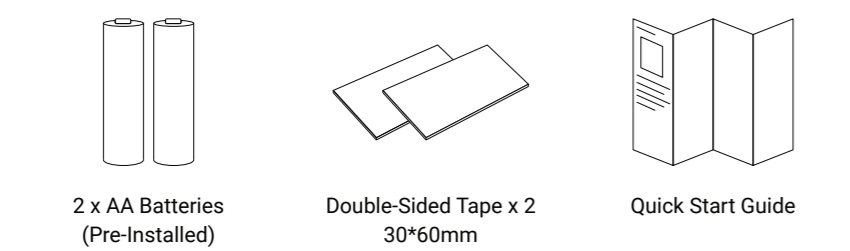
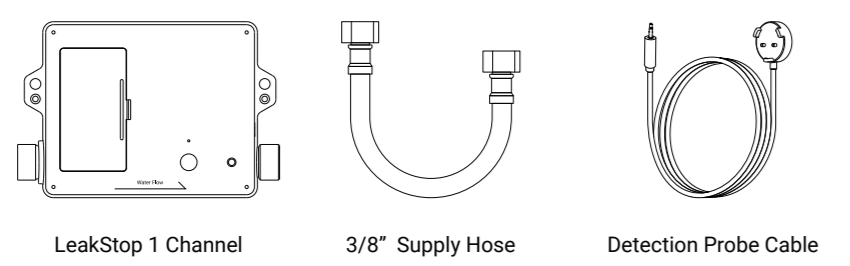

D Required Items

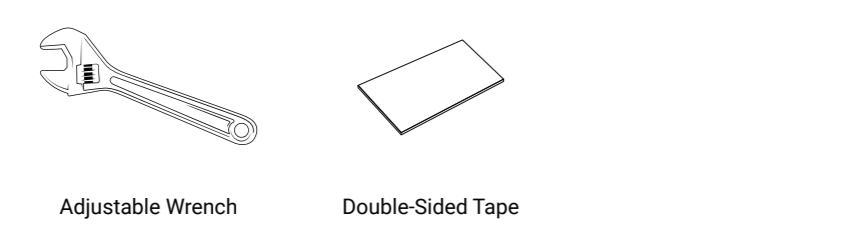

E Get to Know Your LeakStop 1 Channel

LeakStop 1 Channel:

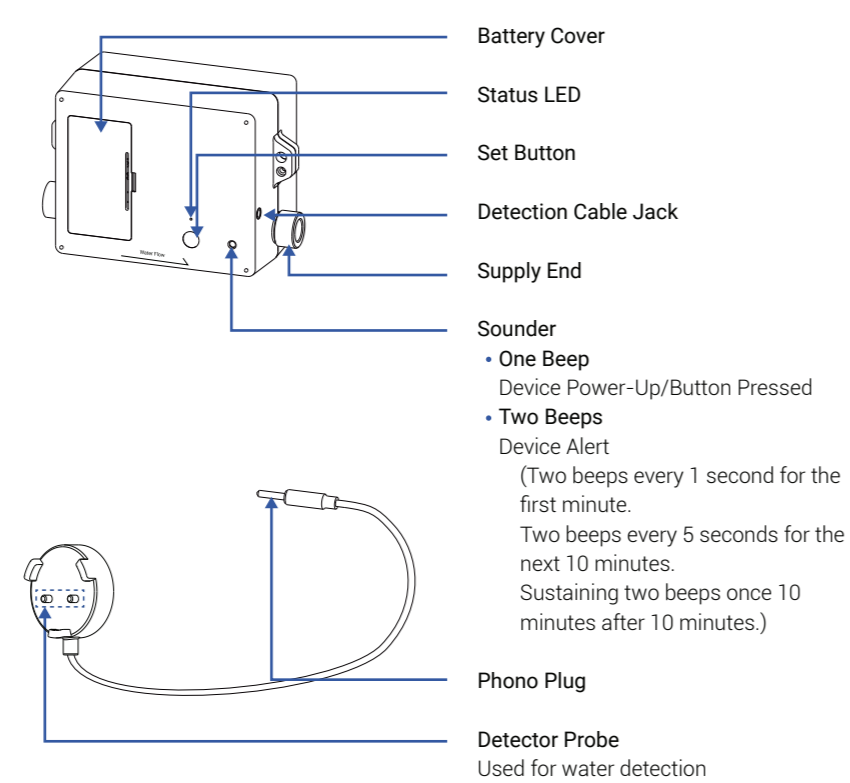

LED Behaviors

- Blinking Red Once, Then Green Once: Device Start-Up
- Blinking Red And Green Alternately: Restoring to Factory Defaults
- Blinking Red Once: Valve Closing or Device Alert
- Blinking Green Once: Valve Opening
- Slow Blinking Green Twice: Connecting to Hub
- Quick Blinking Red Twice: Valve is Closed
- Quick Blinking Green Twice: Valve is Open
- Quick Blinking Green: Control-D2D Pairing in Progress
- Quick Blinking Red: Control-D2D Unpairing in Progress
- Slow Blinking Green: Updating
- Fast Blinking Red Once Every 30 Seconds: Low Battery, Replace Batteries Soon

F Install the App

If you are new to YoLink, please install the app on your phone or tablet, if you have not already. Otherwise, please proceed to the next section.

Scan the appropriate QR code below or find the "YoLink app" on the appropriate app store.



Download on the App Store

Get it on Google Play

Apple phone/tablet iOS 9.0 or higher

Android phone/tablet 6.0 or higher

Open the app and tap **Sign up** for an account. You will be required to provide a username and a password. Follow the instructions, to set up a new account. Allow notifications, when prompted.

G Add Your LeakStop 1 Channel to the App

1. Tap **Add Device** (if shown) or tap the scanner icon:

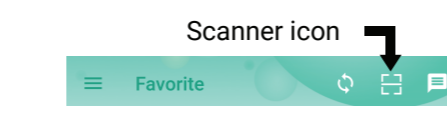

2. Approve access to your phone's camera, if requested. A viewfinder will be shown on the app.

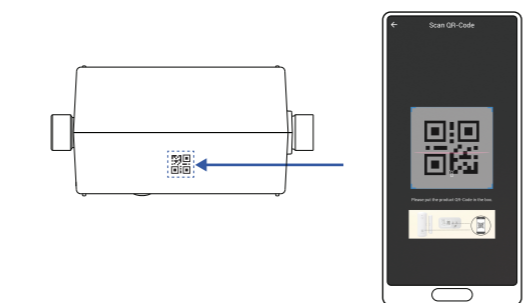

3. Hold the phone over the QR code so that the code appears in the viewfinder. If successful, the **Add Device** screen will be displayed.

4. Follow the instructions to add your LeakStop 1 Channel to the app.

H Before Installation

1. Please install following the water flow direction shown by the arrow.
2. This product defaults to a Maximum Water Usage Duration per Flush of 10 minutes, Maximum Flushes in one day of 20 times, and Maximum Water Usage in one day of 150 gallons. Exceeding any of these limits will automatically close the valve. You can manually reopen the valve in the App (YoLink Hub required) or by pressing the SET button.
3. If you need to modify the default values, please do so on the device detail page within the YoLink App (YoLink Hub required).

I Install the LeakStop 1 Channel

1. Turn off the water valve and loosen the connection between the water valve and the toilet hose.

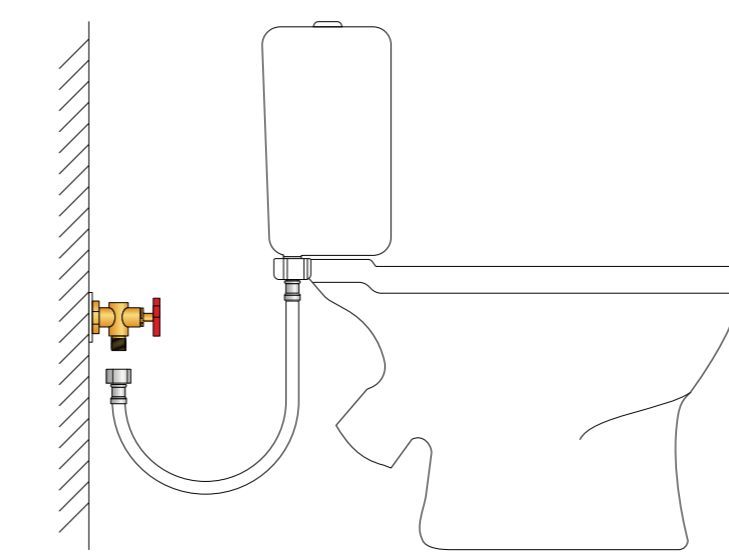

2. Connect the new hose, with one end attached to the valve and the other end to the LeakStop 1 Channel.

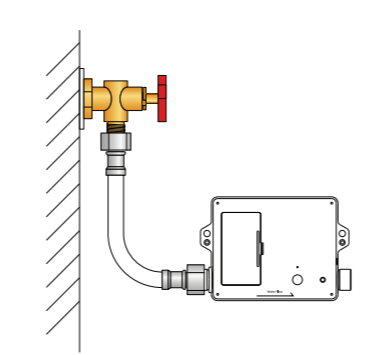

I Install the LeakStop 1 Channel, Continued

3. Reconnect the original hose to the LeakStop 1 Channel.

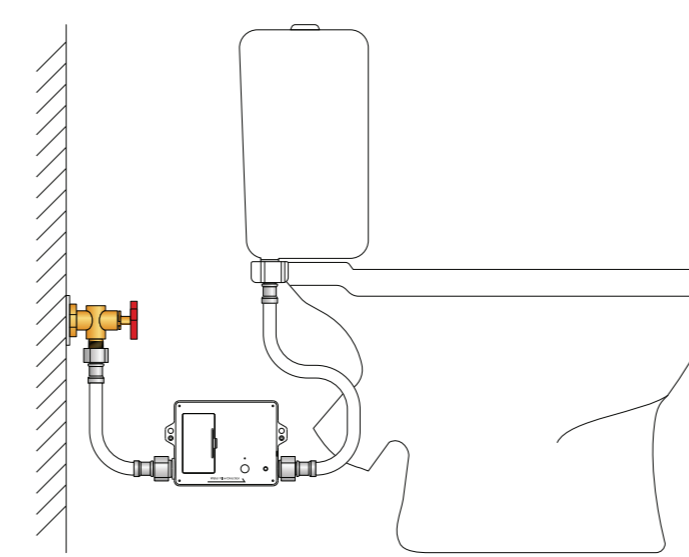

4. Attach the double-sided tape to the back of the LeakStop 1 Channel, peel off the protective film, and secure it to the wall, if required.

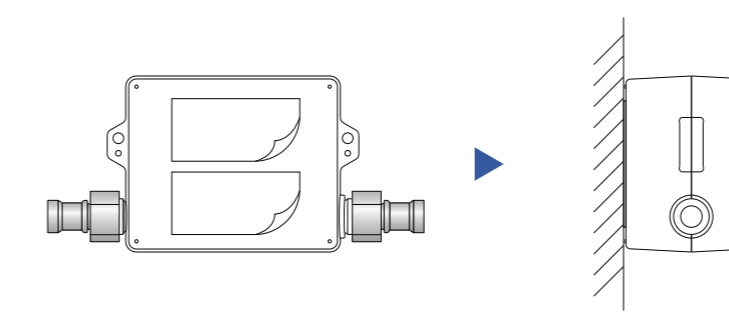

5. Turn on the water valve, then press the SET button to test the LeakStop 1 Channel's on/off functionality.

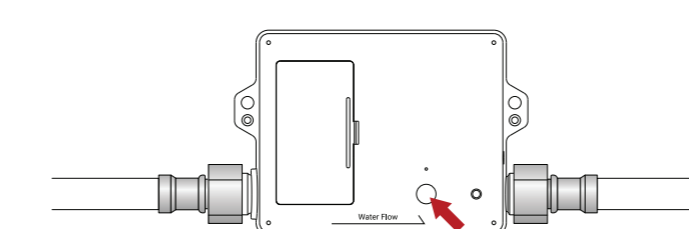

J Install the Probe Detection Cable

1. Connect the cable to the LeakStop 1 Channel, by plugging the male end of the probe cable into the device.

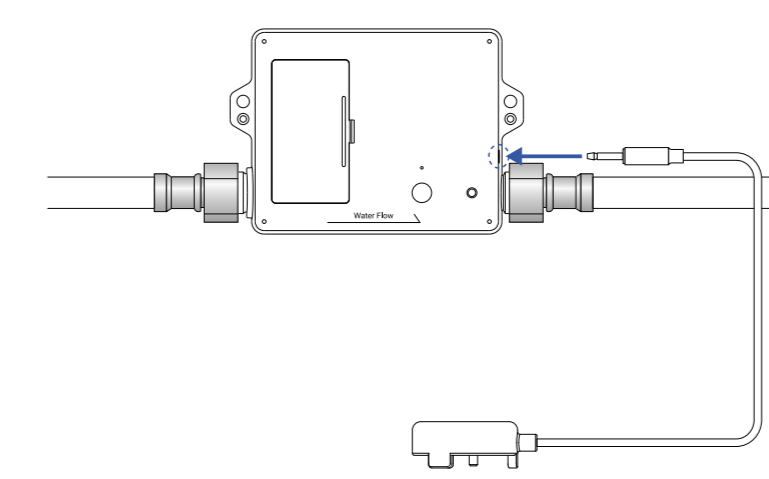

2. Secure the probe cable along the wall, ensuring the cable's end is in close contact with the floor (the device will trigger an alarm when water connects the probes).

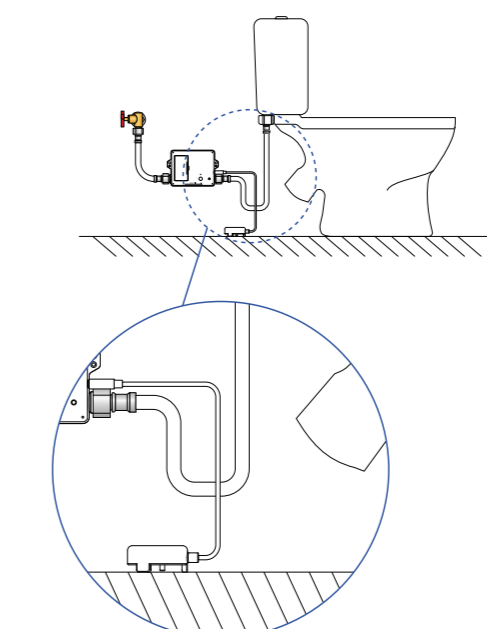

K Power up

Power up the FlowSmart LeakStop 1 Channel by briefly pressing the SET button, until the LED flashes (red, then green).

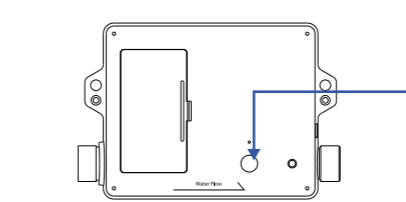

L Contact Us

We are here for you if you ever need any assistance installing, setting up or using a YoLink app or product!

Need help? For fastest service, please email us 24/7 at service@yosmart.com

Or call us at **831-292-4831** (US phone support hours: **Monday - Friday, 9AM to 5PM** Pacific)

You can also find additional support and ways to contact us at: www.yosmart.com/support-and-service

Or scan the QR code:



Support Home Page

Finally, if you have any feedback or suggestions for us, please email us at feedback@yosmart.com

Thank you for trusting YoLink!

YoLink Customer Support



25172 Arctic Ocean Drive, Suite 106 Lake Forest, CA 92630

© 2024 YOSMART INC. CALIFORNIA, USA

*本页校对专用, 不做印刷



型号	品名	料号
YS5009	FlowSmart LeakStop 1 Channel	***

日期	内容	设计师
20240716	新增	
20240926	更新内容, 更新本手册	
20240923	更新内容, 添加安装尺寸	
20240927	更新内容, 删除安装尺寸内容	
20240929	更新内容, 添加安装尺寸内容	
20240930	更新内容, 更新尺寸	
20241009	更新内容, 内容	
20241113	更新本手册	
20241115	更新内容	

备注说明:
1. 颜色 (品牌色) 色值:
潘通 6103CP
PANTONE 6103 CP
RGB: 85 83 151
HEX: #535297
CMYK: 85 69 1 6

印刷说明:
1. 双面彩色印刷+10%双模纸
2. 单页尺寸: 480*270mm

折页图示

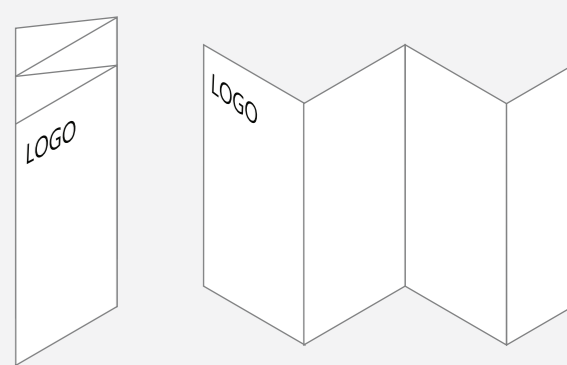

第1页- A面

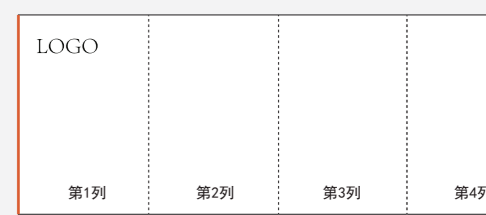

第2页- B面

