

Outdoor Energy Plug

YS6803-UC

Quick Start Guide

Revision Jan. 20, 2024

A Welcome!

Thank you for purchasing YoLink products! We appreciate you trusting YoLink for your smart home & automation needs. Your 100% satisfaction is our goal. If you experience any problems with your installation, with our products or if you have any questions that this manual does not answer, please contact us right away. See the Contact Us section for more info.

Thank you!
YoLink Customer Support

The following icons are used in this guide to convey specific types of information:

Very important information (can save you time!)

B Before You Begin

Please note: this is a quick start guide, intended to get you started on the installation of your Outdoor Energy Plug. Download the full Installation & User Guide by scanning this QR code:



Installation & User Guide

You can also find all guides and additional resources, such as videos and troubleshooting instructions, on the Outdoor Energy Plug Product Support page by scanning the QR code below or by visiting:

<https://www.yosmart.com/support/YS6803-UC>



Product Support
Support produit
Soporte de producto



Your Outdoor Energy Plug connects to the internet via a YoLink hub, and it does **not** connect directly to your WiFi or local network. In order for remote access to the device from the app, and for full functionality, a hub is required. This guide assumes the YoLink app has been installed on your smartphone, and a YoLink hub is installed and online (or your location, apartment, condo, etcetera, is already served by a YoLink wireless network).

C In the Box

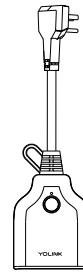

Outdoor Energy Plug

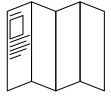

Quick Start Guide

D Get to Know Outdoor Energy Plug

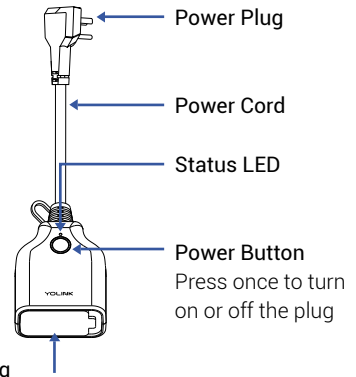



Plug in your device and control it independently from your smartphone

LED Behaviors

- Green
Plug is On
- Red
Plug is Off
- Blinking Green
Connecting to Cloud
- Quick Blinking Green
Control-D2D Pairing in Progress

D Get to Know Outdoor Energy Plug, Continued

-  Slow Blinking Green Updating
-  Quick Blinking Red Control-D2D Unpairing in Progress
-  Blinking Red And Green Alternately Restoring to Factory Defaults

E Install the App

If you are new to YoLink, please install the app on your phone or tablet, if you have not already. Otherwise, please proceed to the next section.

Scan the appropriate QR code below or find the "YoLink app" on the appropriate app store.



Apple phone/tablet
iOS 9.0 or higher

Android phone/
tablet 6.0 or higher

Open the app and tap **Sign up** for an account. You will be required to provide a username and a password. Follow the instructions, to set up a new account. Allow notifications, when prompted.

You will immediately receive a welcome email from no-reply@yosmart.com with some helpful information. Please mark the yosmart.com domain as safe, to ensure you receive important messages in the future.

E Install the App, Continued

Log in to the app using your new username and password.

The app opens to the **Favorite** screen. This is where your favorite devices and scenes will be shown. You can organize your devices by room, in the **Rooms** screen, later.

Refer to the full user guide and online support for instructions on the use of the YoLink app.

F Add the Outdoor Energy Plug to the App

1. Tap **Add Device** (if shown) or tap the scanner icon:

Scanner icon



2. Approve access to your phone's camera, if requested. A viewfinder will be shown on the app.

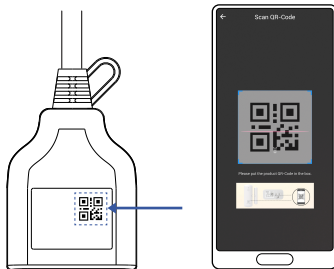

3. Hold the phone over the QR code so that the code appears in the viewfinder. If successful, the **Add Device** screen will be displayed.

4. You can change the device name and assign it to a room later. Tap **Bind device**.

F Add the Outdoor Energy Plug to the App, Continued

5. Plug in the Plug to a 120V AC outlet.
6. To turn the Plug on for the first time, press the Power button briefly, until the LED illuminates.
7. You should now be able to control the Plug from the Power/SET button and from the app.

Proceed to the full Installation & User Guide or the online product support to complete the set up of your Outdoor Energy Plug.

G Contact Us

We are here for you, if you ever need any assistance installing, setting up or using a YoLink app or product!

Need help? For fastest service, please email us 24/7 at service@yosmart.com

Or call us at **831-292-4831** (US phone support hours: **Monday - Friday, 9AM to 5PM Pacific**)

You can also find additional support and ways to contact us at: www.yosmart.com/support-and-service

Or scan the QR code:



Support
Home Page

Finally, if you have any feedback or suggestions for us, please email us at feedback@yosmart.com

Thank you for trusting YoLink!

YoLink Customer Support

YOLINK

25172 Arctic Ocean Drive, Suite 106
Lake Forest, CA 92630

© 2024 YOSMART INC. CALIFORNIA, USA