



# CLASSIC 2-IN-1 FEEDER

Item # 168793

L 21.5" x W 13.06" x H 23.25"

## Component Parts:

### Hardware Package

- 4 bolts - 1/4" x 1" long
- 13 bolts - 1/4" x 1/2" long
- 17 lock nuts - 1/4"

### Hand Tool Needed

- wrench

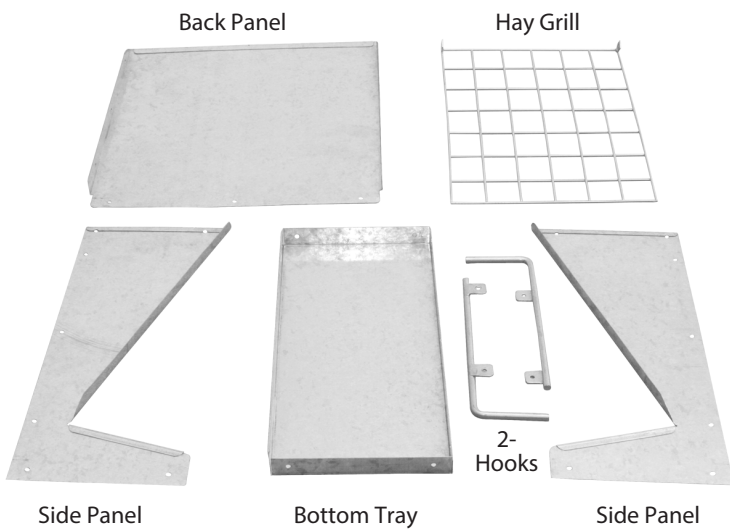
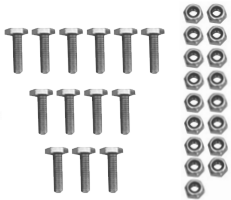

## Assembly & Installation Instructions:

1. Install back panel to bottom tray using 1/4" x 1/2" bolts (back panel goes inside of tray)



## Assembly & Installation Instructions:

2. Install side panels using 1/4" x 1/2" bolts (make sure bottom of side panel is outside of bottom tray and inside of back panel)

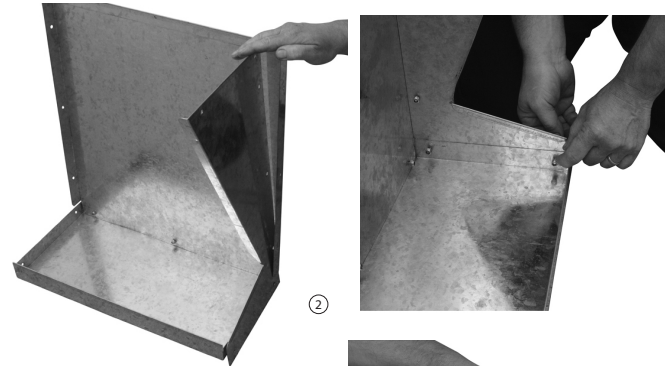

3. Slide hay grill into place.

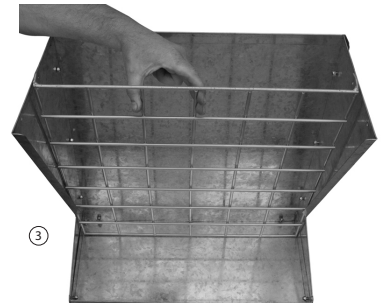

4. Install hooks, use same hole to fasten hay grill and hooks using 1/4" x 1 bolts, tighten all bolts.

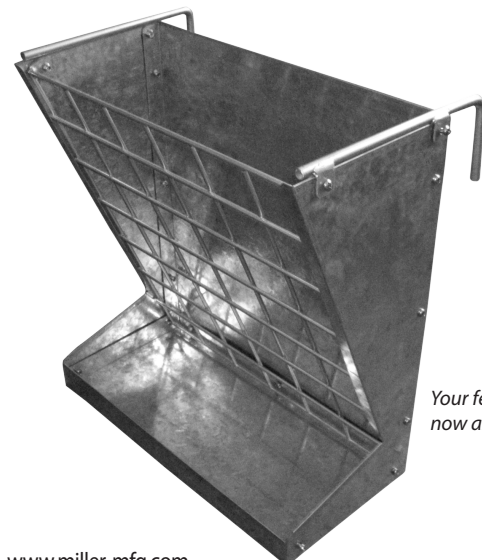
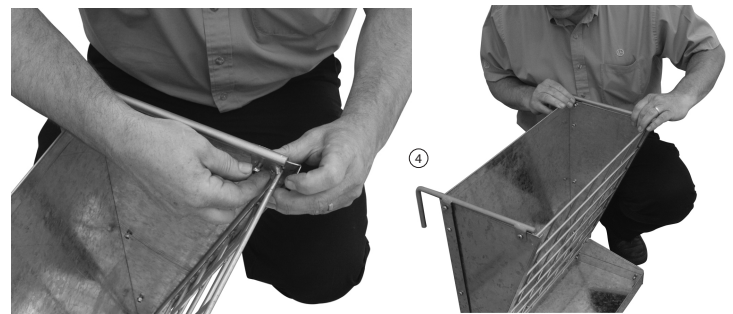

Your feeder is now assembled.